

Induction Heaters for Traction Motor Pinions

These heaters were designed and developed to aid traction motor pinion removal on General Electric Deisel Electric Locomotives. They are used in conjunction with the conventional hydraulic removal equipment.

The procedure was developed as follows: Install the induction heater on the pinion and connect the hydraulic tubing, gage and pump assembly complete with the proper backing plate. Pump the hydraulic assembly until 15,000 PSI is indicated on the gage. Turn the induction heater on for 45 seconds then pump vigorously to complete pinion removal.

For specific details contact TESCO. We can also help provide complete hydraulic equipment per your specific requirements.

- T60170 230 Volt Induction Heater for 752 Motors
- T60171 460 Volt Induction Heater for 752 Motors
- T60220 230 Volt Induction Heater for 761 Motors
- T60221 460 Volt Induction Heater for 761 Motors

**** The T60170 & T60171 also work on EMD motors. ****



T50850 752 Traction Motor Pinion Puller Set

The GE 752 Traction Motor Pinion Puller Set has been re-designed to provide all high pressure fittings rated at 60,000 PSI. The pump provided is rated at 40,000 PSI.

WARNING: This kit is utilized to remove 752 traction motor pinions hydraulically. Pinion retainer plates which bolt into the end of the armature shaft must be utilized when operating this equipment.

NOTE: Tubing as illustrated with 2 - T50730 Tubing Sleeves and 2 - T50870 Gland Nuts is catalog # T50920.

*Should you require Pinion Retainer Plates, TESCO will build them to order.

T50890 Retainer Plate for GE 752 armature Shaft with threaded end.

T50900 Retainer Plate for GE 752 Armature Shaft with two threaded 1.00" - 8 holes on end of shaft.

T50910 Retainer Plate for GE 752 Armature Shaft with one threaded 1.00" - 8 hole on end of shaft.

T50850GK Gauge Kit - this kit includes a 0-30,000 PSI gauge and manifold complete with all high pressure connections to be inserted between the pump and tubing assembly.



1	1-T50860 Hydraulic Pump (40,000 PSI)
2	1-T50740 High Pressure Pump to Tubing Assembly
3	2-T50730 Tubing Assembly
4	2-T50870 Gland Nut
5	1-T50920 Tubing assembly with 2-T50730 Sleeves and 2-T50870 Nuts
6	1-T50880 Armature Shaft Pressure Adapter
	1-T50720 Tubing (only)



TRANSPORTATION EQUIPMENT SUPPLY CO.

T52210K Traction Motor Axle Cap Torque Kit

This kit consists of a 5 to 1 verifier, rated at 1250 lb.ft., with a 3/4" square female input and a 1" square male output. The kit also includes 2 - 1 7/8" sockets, 2 - 2" sockets, 2 - 2 1/4" sockets, 1 - 10" extension, 1 - 16" extension, 1 - universal joint and a storage box.

Most locomotive traction motors can be serviced with these tools.

1	T52210	5:1 Verifier
2	T52210-S1	1 7/8" Socket (2 Required)
3	T16000	2" Socket (2 Required)
4	T52210-S2	2 1/4" Socket (2 Required)
5	T52210-E10	Extension 10"
6	T52210-E16	Extension 16"
7	T52210-UJ	Universal Joint
8	T52210-SB	Storage Box



T58300

Gear Case Torque Kit for AG and AH Traction Motors

This kit torques both AH and AG Gear Case Bolts quickly and properly.

1	T58300-AM	Torque Motor (1,500 lb.ft. max)
2	T58300-RAG	Reaction Arm
3	T58300-S	AH Drive Socket
4	T58300-SAG	AG Drive Socket
5	T58300-2	AH Standoff Adapter
6	T58300-AGSO	AG Standoff Adapter
7	T50041	Air Control Kit

T58080 Cam Car Installation and Removal Kit

This kit was designed for use on the GE AC traction motor nose supports. It is used to install Cam Car Bolts by twisting the drive tang off ensuring proper installation. In addition a removal socket is included for removal of the bolt.

CAUTION: Ensure that the air motor is running off clean air supply with a mist of lubricating oil.

1	T58080-AM Torque Motor
2	T58080-RA Reaction Arm
3	T58080-RS Reaction Socket
4	T58080-CS Cam Car Installation Socket
5	T58080-CRS Cam Car Removal Socket



AG and AH Spot Facing Tools



These tools are used to resurface the bolting surface on used gear cases that were run with loose joints. They reestablish proper bolting surfaces.



T58430-6	AH Spot Facing Tool
T58580	AG Spot Facing Tool

T51560 Universal Traction Motor Pinion Advance Gauge

This gauge is improved over prior two leg models in that with three legs an exact plane can be established and very accurate readings obtained. The gauge is calibrated in .001" increments and will accept advance readings up to .250".

Three leg diameter positions are provided to ease working on various diameter pinion applications.



T59670 Traction Motor Pinion Application Tools

For use on GE 752 Traction Motors. Similar kit for GE 761 Traction Motor is also available.

Ref.	T. #		Description:
	T59670	Includes:	
1		*	Hydraulic Pump Kit with Gage & Hose Assy. (Set to relieve at 7000PSI)
2		*	Cold Snap Pinion Puller
4		*	Pressing Plate
5		*	Snubber Assembly
6		*	Centering Stud
3	T59700		Mechanical Pinion Advance Tool
8	T59680	Includes:	T59680 Pinion Advance Gage Assembly
7		*	"0" Setting Gauge Plate
9	T59690-22		22 Tooth Hot Stop
10	T59690-20		20 Tooth Hot Stop
11	T59690-18		18 Tooth Hot Stop

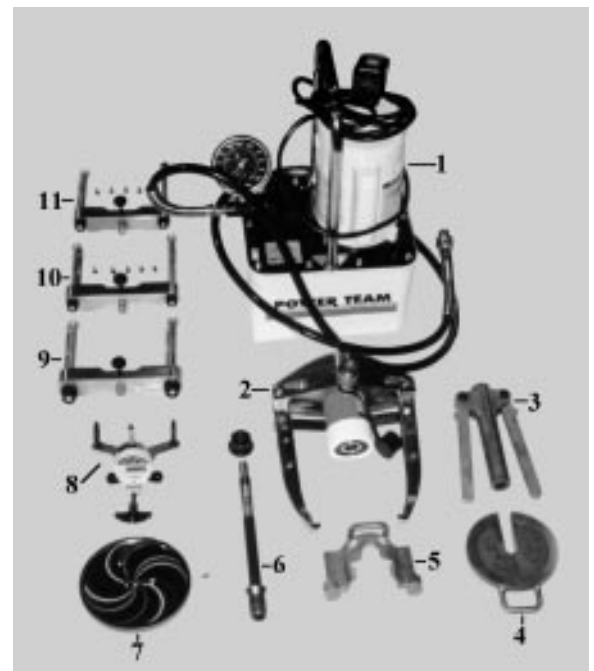



T51630 Spanner Wrench

Specifically designed for commutator end, bearing nuts on GE-752 Traction Motors.

1	T51630P Pin (2 required)
2	T51630S Screw (2 required)

T50490 Armature Shaft/Pinion Taper Gauge Set for GE 752 Motors

For use with GE Traction Motors.
Refer to GE Maintenance Instructions for details of operation.

T59710 Taper Gauge Set for GE 761 Motors (Not Shown)

T59720 Taper Gauge Set for EMD Domestic Motors (EMD Ref# 8040553) Not Shown



T58592 AC Traction Motor Speed Sensor Installation and Removal Kit

This kit was developed to aid the difficult removal and installation of speed sensors on GE AC Traction Motors. All assemblies have been pinned together and are equipped with lanyards to prevent dropping components into the traction motor cavity. **If dropped they must be removed.** The head of the sensor mounting bolt is 1/2" across the flats. The various combination of wrenches are useful to provide random access to difficult bolt head locations.

The T58592 kit was recently developed to address the newer truck styles that could not be accessed with the old kit. An inspection flashlight and telescoping magnet have also been included.

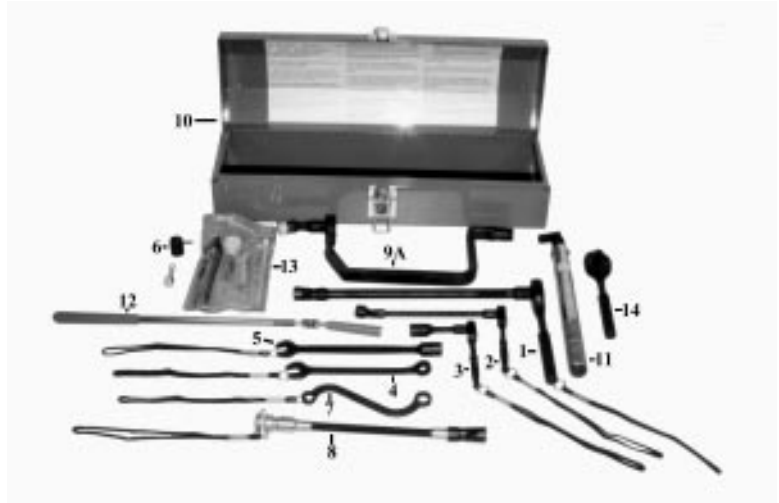

1	T58591-1	Ratchet, Extension & Universal
2	T58591-2	Ratchet, Extension & Universal
3	T58591-3	Ratchet, Extension & Universal
4	T58591-4	Box Wrench
5	T58591-5	Flex Box Wrench
6	T58591-6	Socket
7	T58591-7	"S"Pattern Wrench
8	T58591-8	Flex Extension & Socket
9	T58592-9A	Torque Adapter
10	T58592-10	Box
11	T58592-11	Torque Handle set at 15 lb.ft.
12	T58592-12	Magnetic Retriever
13	T58592-13	Inspection Light and Mirror
14	T58592-14	3/8" Ratchet